

**RIGHT SIZE** *your life* to the **NEW MERCEDES**  
**YOU CAN HAVE THE RIGHT HOME... AT THE RIGHT PRICE... RIGHT NOW!**

# Rim Rock

**\$5,000  
 Realtor  
 Bonus**



~~\$460,465~~ **\$429,990**

**622 Bluff Woods Drive**

- ◆ 3,388 Sq. Ft., 4 Bedroom, 3.5 Bath, Side Load 3-Car Garage, Game Room, Wood Flooring  
**READY NOW!! - Tiffany Plan**

~~\$429,588~~ **Now \$389,990**

**280 Bluff Woods Drive**

- ◆ 2,976 Sq. Ft., 3 Bedroom, 2.5 Bath, Side Load 3-Car Garage, Tray Ceilings at Master & Dining  
**READY NOW! - Taylor Plan**

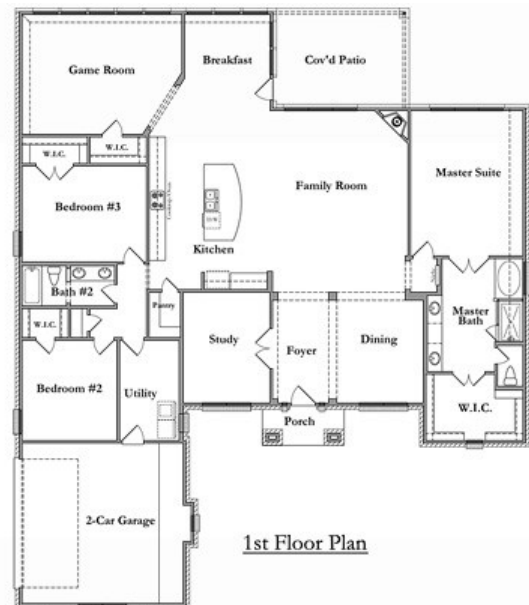
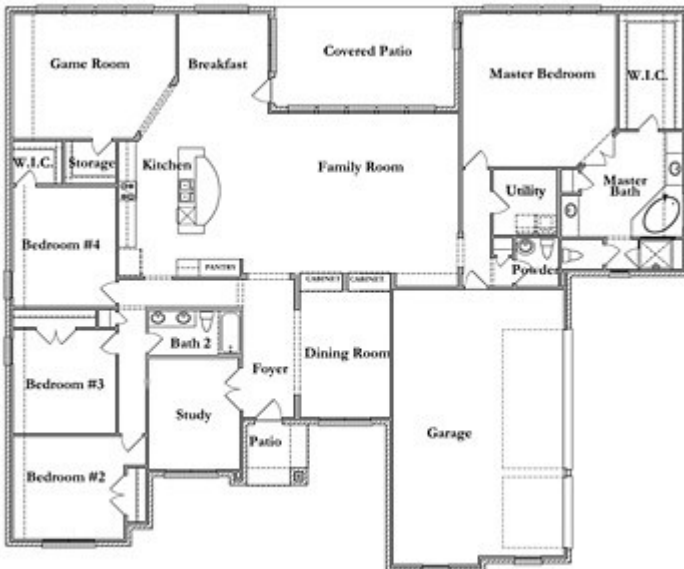

**Rim Rock offers gorgeous 1 acre home sites in the highly desirable Dripping Springs area. Just minutes from Austin's famous Salt Lick BBQ, Grey Rock Golf Club, shopping and more!**

Directions: Take Loop 1 (Mo Pac) South to SH-45. Left on FM-1826. Travel 5.1 miles to the first entrance of Rim Rock. Left on Arbor Canyon Pass. Right onto Hawthorne Loop. The Model Home will be located on the right.

Contact: Daphne Amin — [damin@merhomes.com](mailto:damin@merhomes.com) or Marissa Van Bibber [mvanbibb@merhomes.com](mailto:mvanbibb@merhomes.com)  
 Sales Counselors 512-858-4700



We reserve the right to make changes to these floor plans, specifications, dimensions, and elevations without prior notice. State dimensions and square footages are approximate and should not be used as exact representation to the home's size. Photos are for illustration purposes only; they may be of model or showcase versions of a similar home.